



# Instruction Manual

USS-DBS81 Analytical Balance



# Table of Contents

|                               |    |
|-------------------------------|----|
| Introduction.....             | 1  |
| 1.1 Safety Precautions.....   | 1  |
| Design and Function.....      | 3  |
| 2.1 Components.....           | 3  |
| 2.2 Keyboard.....             | 4  |
| 2.3 Display Panel.....        | 5  |
| Unpacking.....                | 6  |
| Before Using.....             | 7  |
| 4.1 Leveling the balance..... | 7  |
| 4.2 Calibration.....          | 8  |
| Operation.....                | 9  |
| 5.1 Basic Weighing.....       | 9  |
| 5.2 Unit Switching.....       | 10 |
| 5.3 Counting.....             | 10 |
| Setting.....                  | 12 |
| 6.1 Minimum weighing.....     | 12 |
| Technical Data.....           | 13 |

# Introduction

Thank you for choosing the U.S. Solid USS-DBS81 Series Analytical Balance.

The USS-DBS81 Analytical Balance is precise and reliable. It offers a high level of operating convenience and response sensitivity to facilitate determination of the weight of your samples. In addition, USS-DBS81 Analytical Balance provides **dual** (one front and one rear) **display screens**, which can be used not only for various scenarios that ordinary single-screen balances can be used, but also for special use scenarios that single-screen ordinary balances can not meet.

U.S. Solid's dedicated customer service staff are available to answer any inquiries regarding applications and accessories.

Please read the manual completely and follow the usage instructions before installation and operation as this will help you to make full use of the functions and performance of the USS-DBS81 Analytical Balance.

## 1.1 Safety Precautions

The U.S. Solid USS-DBS81 Analytical Balance qualifies as state-of-the-art technology and complies with all recognized safety rules. Improper use or handling, however, can result in damage and/or injury. Please follow

the precautions below to ensure safe and trouble-free operation of your balance.



- The balance has a 3-pin power socket equipped with a ground terminal. To prevent electric shock and to maintain stability in operation of the balance, be sure to ground the balance.
- Avoid getting the balance wet as it is not water resistant. Any leakage of liquid into the balance may damage the balance or cause an electric shock to the user.



- Use a power source (voltage, frequency, outlet type) adapted to the specification of the balance. If excessive voltage is used, the balance may overheat and be damaged or cause a fire.



- Operate the balance on a stable, rigid and flat table.
- Handle the balance carefully. It is a precision device, subjecting it to impact may result in a malfunction.
- If the device is not be used for a long period of time, the power should be turned off and disconnect the power cable.
- Do not disassemble, remodel or repair this product or accessories.
- Do not weigh items larger than the balance's range, as this may damage the load cell of the balance.

# Design and Function

## 2.1 Components

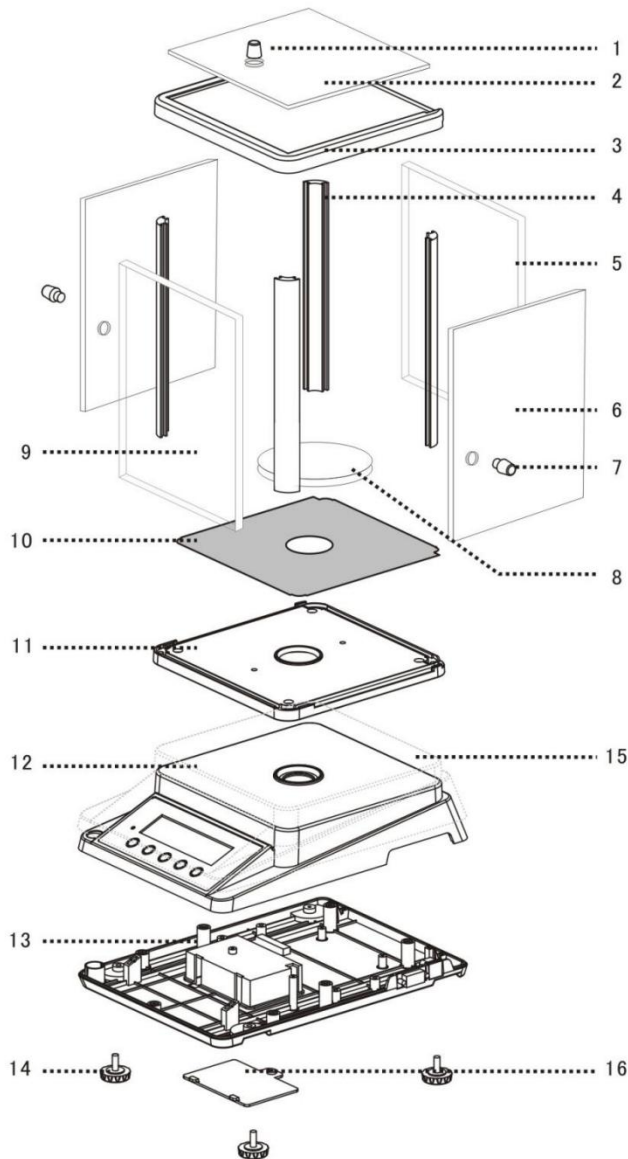

1: Upper Handle

2: Upper Glass

3: Housing I

4: Vertical Strut

5: Rear Glass

6: Side Glass

7: Side Handle

8: Weighing Pan

9: Glass

10: Tray

11: Housing II

12: Housing III

13: Housing IV





14: Leveling foot

15: Dust Cover

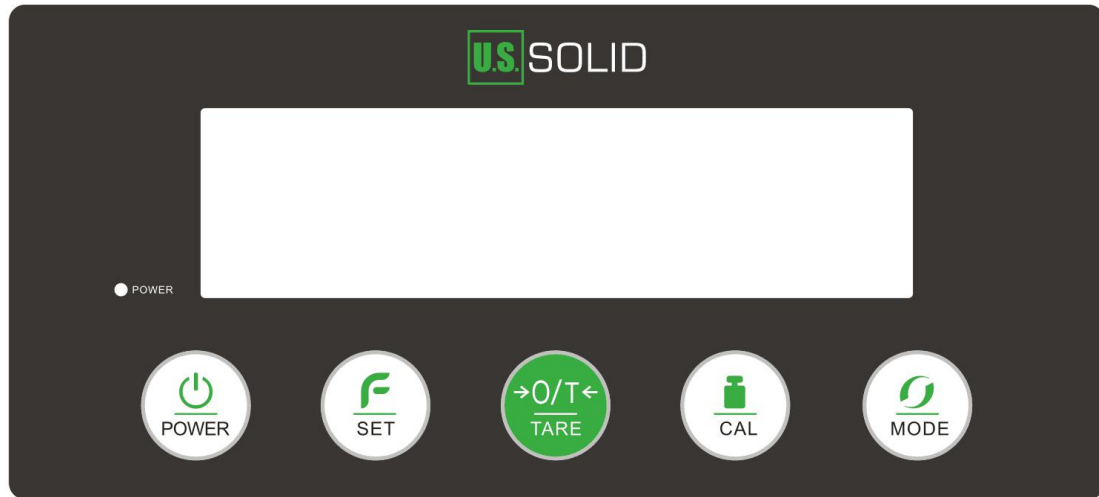
16: Battery Cover

## 2.2 Keyboard



| Key   | Description  |
|---|--|
|  | Turn the power on or off                                   |
|  | Enter the counting function                                |
|   | Long press with "TARE" to enter the minimum weight setting |
|  | Tare the balance   |
|   | Long press with "SET" to enter the minimum weight setting  |
|  | Performs weight calibration                                |
|  | Switch the weighing units                                  |

## 2.3 Display Panel

USS-DBS81 Analytical Balance provides dual display screens, one front and one rear.

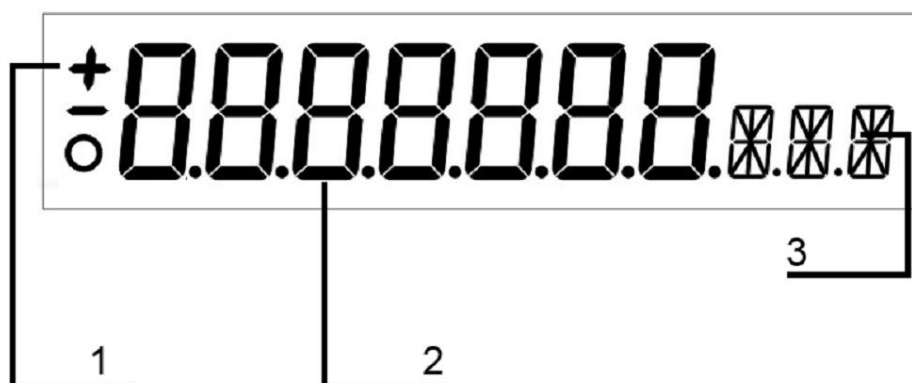

| No. | Description   |
|-----|---|
| 1   | “+”: Indicates positive values  |
|     | “-”: Indicates negative values  |
|     | “ O ”: Stabilization indicator (Disappearance indicates stabilization of balance) |
| 2   | Weight value  |
| 3   | Weight unit   |

# Unpacking

The USS-DBS81 Analytical Balance is a precision instrument. Unpack the balance carefully and check the delivered items for completeness.

The following accessories are part of the standard equipment for your new USS-DBS81 Analytical Balance:

- 1 Balance Main Body
- 1 Weighing Pan
- 1 Draft Shield
- 1 Power Cable
- 1 Calibration Weight
- 1 Instruction Manual
- 1 Quality Certification

Check the instrument for damage in transit. Immediately inform the U.S. Solid customer service if you have any complaints or parts are missing.



# Before Using

- Adjust the leveling feet of the analytical balance until the air bubble in the indicator is centered.
- Warm up for 30 to 60 minutes after starting up to improve the stability of weighing.
- Check the accuracy of the reading with the weight. If there is any deviation, please follow the calibration method below to calibrate the balance.

## 4.1 Leveling the balance

Accurate horizontal positioning necessary for repeatable measurements and exact results. To compensate for small irregularities or tilts at this location, the instrument needs to be leveled.

Adjust the leveling feet of the analytical balance until the air bubble in the indicator is centered. The level indicator is located under the cover towards the rear of the analytical balance.

## 4.2 Calibration

Calibration is a necessary step to assure the analytical balance will accurately weigh the sample.

Perform calibration operations in the following situations:

- Changes in the location of use (including moving in the same room).
  - Changes in ambient conditions.
  - Prior to each use.
1. Zero the balance in the weighing state;
  2. Press the “CAL” button and “--CAL--” will be displayed;
  3. After that “200.000” (or “100.000”) will be flashing displayed, then place the calibration weight on the pan ;
  4. “-----” will be displayed, then “200.000” (or “100.000”) will be displayed again;
  5. Remove the calibration weight and “-----” will again displayed.
  6. The calibration is completed and it will return to the weighing interface.

# Operation

## 5.1 Basic Weighing

1. Zero the balance in the no-load state.
2. Open the glass door of the weighing chamber and place the weighing sample on the weighing pan, then close the glass door.
3. After the display stabilizes, read the value displayed.

Weighing a sample that needs to be in a container:

1. Open the glass door of the weighing chamber and place the weighing container on the weighing pan, then close the glass door again.
2. Wait for the display to stabilize. Then press "O/T" to tare, and the displayed value will return to zero.
3. Open the glass door and place the sample(s) to be weighed in the weighing container, then close the glass door.
4. After the display stabilizes, read the value displayed.

## 5.2 Unit Switching

The USS-DBS81 Analytical Balance offers four weight units of “g”, “oz”, “ct” and “gn”. The unit selection function can be used to meet the unit requirements in various usage situations.

In the weighing state, press the "mode" button to switch weight units.

## 5.3 Counting

The U.S. Solid USS-DBS81 Analytical Balance has a built-in counting function that meets various industrial counting requirements, especially the counting function for small components.

To ensure the accuracy of the counting function for small components, it is necessary to ensure that the weight of all samples is consistent, and that the weight of a single object is  $\geq 0.004\text{g}$ .

1. Press “SET” and “--COU--PCS” will be displayed;
2. After that “10 PCS” will be flashing displayed;
3. Press “ON” to select the quantity and put the corresponding quantity of samples on the pan;
4. Press “SET” to confirm and “-----PCS” will be displayed;

5. Put samples to be counted after the “10 PCS” again displayed and the corresponding number appears.

Exit counting function:

1. Press “SET” and “-----” will be displayed;
2. After that “--ERR--” will be flashing displayed;
3. Press “SET” to exit the counting function and return to the weighing interface.

# Setting

## 6.1 Minimum weighing

The minimum weight can be set according to the use requirements.

1. Long press "TARE" and "SET" simultaneously until "1 d" displayed;
2. Press "SET" or "CAL" to turn up or turn down respectively (from "1d" to "5d", "d" means minimum scale value 0.001 g);
3. Press "TARE" to confirm.

# Technical Data

| <b>Model</b>        | <b>USS-DBS81-<br/>110G</b> | <b>USS-DBS81-<br/>210G</b> | <b>USS-DBS81-<br/>310G</b> |
|---------------------|----------------------------|----------------------------|----------------------------|
| Capacity            | 110 g                      | 210 g                      | 310 g                      |
| Calibration Weight  | 100 g                      | 200 g                      | 200 g                      |
| Readability         | 0.001g (1 mg)              |                            |                            |
| Repeatability       | ±0.002 g                   |                            |                            |
| Linearity Deviation | ±0.003 g                   |                            |                            |
| Stabilization Time  | Within 3 seconds           |                            |                            |
| Pan Size            | Φ 3.55 inches (90 mm)      |                            |                            |
| Interface           | RS232                      |                            |                            |
| Display Screen      | Dual                       |                            |                            |
| Power               | 110V 60Hz AC               |                            |                            |
| Dimensions          | 10.6×7.9×10.6 inches       |                            |                            |
| Net Weight          | 7.72 lbs                   |                            |                            |
| Shipping Weight     | 8.82 lbs                   |                            |                            |

## **Contact**

Feel free to visit our website: [www.ussolid.com](http://www.ussolid.com)

You can email us at [service@ussolid.com](mailto:service@ussolid.com)

You can call one of our friendly customer service representative at

+1(800) 209-4177