

3 Way Manual Ball Valve

Thank you for purchasing our U.S. Solid 3 - Way Ball Valve. We truly value your patronage! Our goal is to enable you to fully utilize your new equipment. To this end, we've prepared some useful tips to assist you in getting started. This manual contains clear wiring diagrams, schematics, and specifications for your valve. Just unfold the manual to access this valuable information.

THREADING

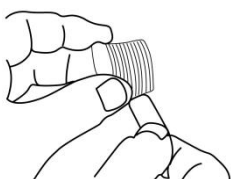

U.S.Solid Valves conform to National Standards for pipe thread. In the United States, we use NPT. We advise using Teflon tape to ensure that the NPT threading is sealed properly. Please refer to the illustration on the left for further guidance.

FLOW DIRECTION (T Type)

- Situation1: Water enters from the bottom port.
 - a. When the handle is turned to the right, water flows out from the left side.
 - b. When the handle is turned to the left, water flows out from the right side.
 - c. When the handle is turned to the bottom, water flow is blocked.

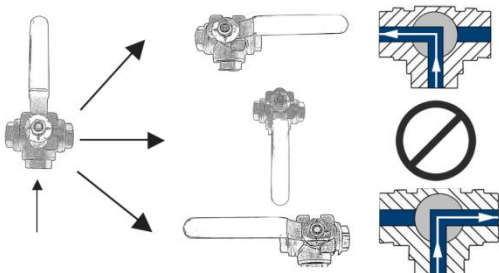

- Situation2: Water enters from the left port.
 - a. When the handle is turned to the right, water flows out from the bottom side.
 - b. When the handle is turned to the left, water flow is blocked.
 - c. When the handle is turned to the bottom, water flows out from the right side.

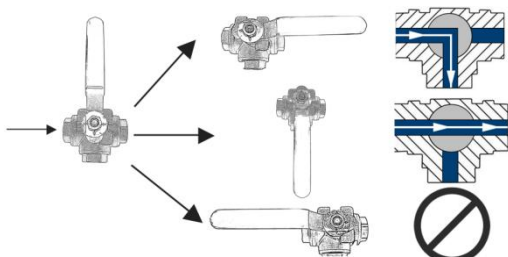

■ Situation3: Water enters from the right port.

- When the handle is turned to the right, water flow is blocked.
- When the handle is turned to the left, water flows out from the bottom side.
- When the handle is turned to the bottom, water flows out from the left side.

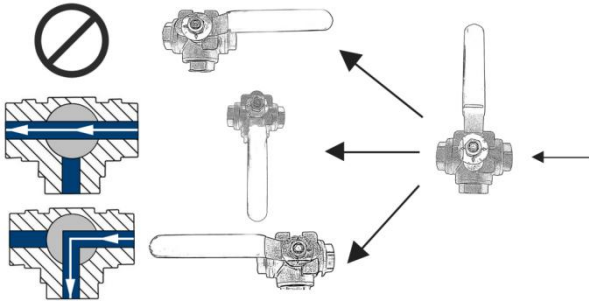

FLOW DIRECTION (L Type)

■ Situation1: Water enters from the bottom port.

- When the handle is turned to the right, water flows out from the left side.
- When the handle is turned to the upward, water flows out from the right side.

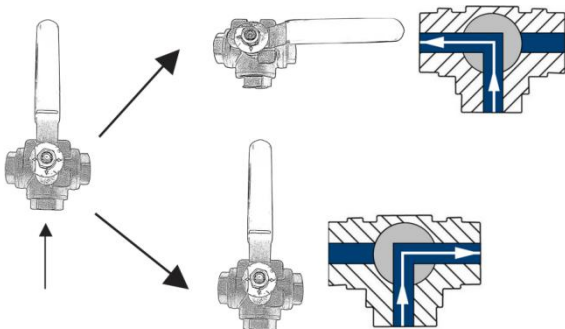

■ Situation2: Water enters from the left port.

- When the handle is turned to the right, water flows out from the bottom side.
- When the handle is turned to the upward, water flow is blocked.

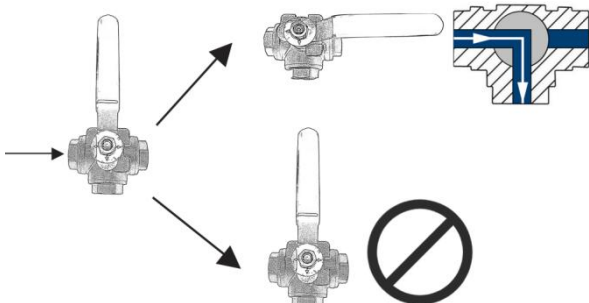

■ Situation3: Water enters from the right port.

- When the handle is turned to the right, water flow is blocked.
- When the handle is turned to the upward, water flows out from the bottom side.

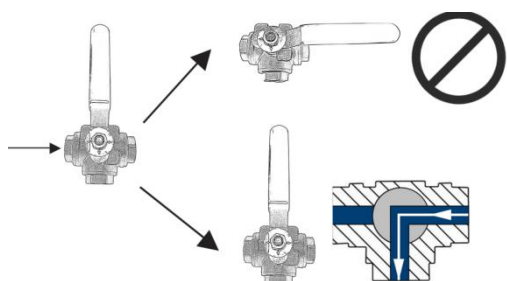

WARNING

1. The valve should be stored in a dry and well-ventilated indoor area.
2. The valve must remain in the closed position during storage and periods of inactivity to ensure proper sealing.
3. Before installation, verify that the valve's model, specifications, and technical performance align with usage requirements. Clean the internal cavity and exterior surfaces to remove dirt, sediment, and rust.
4. Keep the valve clean during operation, and lubricate the stem threads regularly.

SPECIFICATIONS

Model	Type	DN	Material	Port Size
USS-BV21	L	DN15	SS304	1/2"
USS-BV22	L	DN20	SS304	3/4"
USS-BV23	L	DN25	SS304	1"
USS-BV24	T	DN15	SS304	1/2"
USS-BV25	T	DN20	SS304	3/4"
USS-BV26	T	DN25	SS304	1"
Sealing	PTFE			
Max. Pressure	2.5 MPa			
Applicable Temperature	-20°C-220°C(-4°F-428°F)			
Applicable Media	water, oil, gas			